



# DEUTSCH 983 Series Hermetic Connectors with Size 22 Contacts

High-Density Connectors - Qualified and Certified to EN2997 Specification for Temperatures up to 260°C

# DEUTSCH 983 Series Hermetic Connectors with Size 22 Contacts

## Space-Saving Connectors Qualified and Certified to EN2997



DEUTSCH 983 series connectors from TE Connectivity (TE) now include the first hermetic EN2997 connectors in the industry rated to 260°C and offering size 22 contacts. Designed to mate with standard plugs, the connector's high contact density makes it possible to reduce equipment size and allow more electrical connections in the same space.

Designed for reliable performance in extreme vibration, high-temperature environments in military and commercial aircraft engine and booster applications, 983 series connectors are qualified to the EN2997 specification for high-temperature engine connectors.

### HIGH DENSITY

- Size 22 contacts for high contact density in the smallest space
- Reduced weight, same performance
- Allows more electrical connections in a smaller footprint

### HERMETIC

- Ideal for connections with differential pressures
- High reliability

### HIGH PERFORMANCE

- Operating temperatures up to 260°C
- High vibration resistance
- EN2997 qualified and certified
- Self-locking, anti-rotation, and shell-to-shell metal bottoming

### APPLICATIONS

- Commercial Air
- Helicopters
- Military
- Sensors

### MATERIALS

- **Shell:** Stainless steel
- **Insert:** Sintered glass
- **Contacts:** Gold-plated ferrous alloy, solder type

### ENVIRONMENTAL/ MECHANICAL

- **Temperature Range:**
  - Class Y:** -65°C to 200°C
  - Class YE:** -65°C to 260°C
- **Durability:** 500 mating cycles
- **Salt Spray:** 500 hours
- **Vibration:** 10 to 2000 Hz, 3 axes (EN2591-403, method B)
- **Shock:** 300 g/3 ms (EN2591-402)

### ELECTRICAL

- **Insulation Resistance:**
  - At 25°C and 65% RH:** > 5000 MΩ
  - At 260°C and 65% RH:** > 1000 MΩ
- **Dielectric Withstanding Voltage (50 Hz, Mated Connectors):**
  - At Sea Level:** 1500 V<sub>rms</sub>
  - At 15,000 m:** 1000 V<sub>rms</sub>
  - At 30,000 m:** 1000 V<sub>rms</sub>

### Part Numbers

For receptacles with pin contacts and normal (N) keying. Consult TE for other configurations.

Class	Size/ Insert	Receptacle Part No.		
		Square Flange	Round Flange Solder	Jam Nut
Y	08-06	983-OY 08-06 PN	983-1Y 08-06 PN	983-7Y 08-06 PN
	10-12	983-OY 10-12 PN	983-1Y10-12 PN	983-7Y 10-12 PN
	12-21	983-OY 12-21 PN	983-1Y 12-21 PN	983-7Y 12-21 PN
YE	08-06	983-OYE 08-06 PN	983-1YE 08-06 PN	983-7YE 08-06 PN
	10-12	983-OYE 10-12 PN	983-1YE 10-12 PN	983-7YE 10-12 PN
	12-21	983-OYE 12-21 PN	983-1YE 12-21 PN	983-7YE 12-21 PN

### TE Components . . . TE Technology . . . TE Know-how . . .

AMP | AGASTAT | CII | HARTMAN | KILOVAC | MICRODOT | NANONICS | POLAMCO | Raychem | Rochester | DEUTSCH  
SEACON Phoenix | LL ROWE | Phoenix Optix | AFP | SEACON

Get your product to market faster with a smarter, better solution.



### Insert Arrangements



08-06

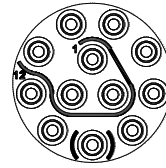

10-12

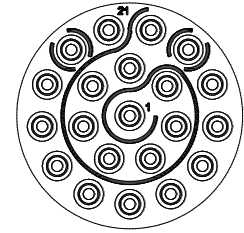

12-21

### Dimensions

#### Square Flange Receptacle, Type O

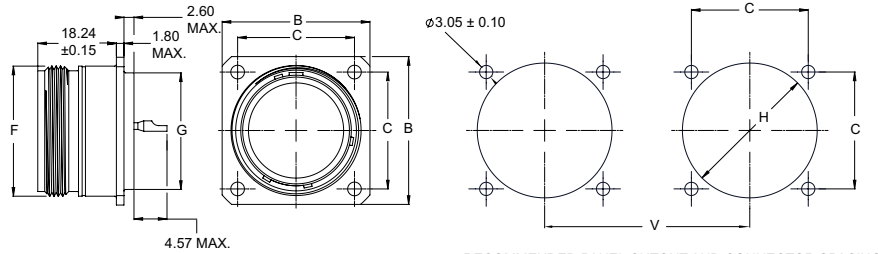

RECOMMENDED PANEL CUTOUT AND CONNECTOR SPACING

Shell Size	B Max.	C ±0.05	F Max.	G Max.	H Min.	V Min.	Mass Max. (g)
08	20.75	15.09	14.27	12.70	15.80	31.70	18
10	23.93	18.26	17.67	14.27	18.70	34.90	24
12	26.32	20.62	22.22	19.05	23.40	39.60	31

#### Round Flange Solder Receptacle, Type 1

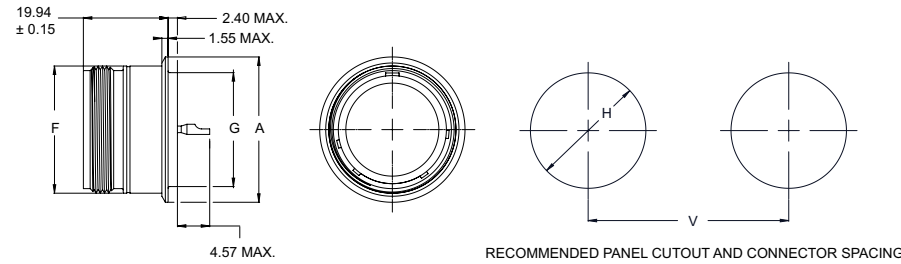

RECOMMENDED PANEL CUTOUT AND CONNECTOR SPACING

Shell Size	A +0/-0.2	F Max.	G Max.	H Min.	V Min.	Mass Max. (g)
08	18.36 17.86	14.27	12.70	12.96	31.70	15
10	21.59 21.08	17.67	14.27	14.53	34.90	21
12	26.80 26.29	22.22	19.05	19.30	39.60	31

#### Jam Nut Receptacle, Type 7

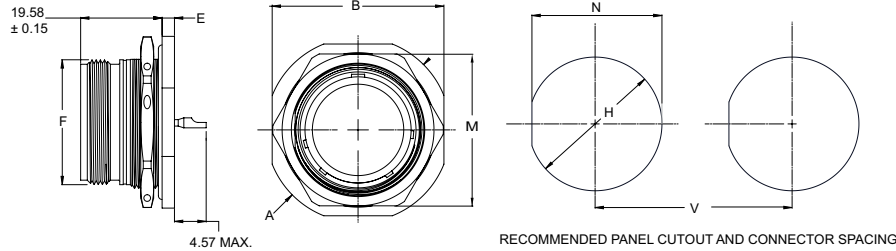

RECOMMENDED PANEL CUTOUT AND CONNECTOR SPACING

Shell Size	A Max.	B Max.	E Max.	F Max.	H Max.	M Max.	N	V Min.	Mass Max. (g)	Panel Nut Torque (m.N Max.)
08	27.38	24.89	3.48	14.27	16.26	21.06	15.50	31.70	29	7
10	30.28	28.04	3.48	17.67	19.43	24.23	18.67	34.90	37	10
12	35.05	32.79	3.48	22.22	24.18	29.01	23.42	39.60	50	12

## LET'S CONNECT

We make it easy to connect with our experts and are ready to provide all the support you need. Just call your local support number or visit [www.te.com/industrial](http://www.te.com/industrial) to chat with a Product Information Specialist.

## Technical Support

[te.com/support-center](http://te.com/support-center)

North America	+1 800 522 6752	Asia Pacific	+86 400 820 6015
North America (Toll)	+1 717 986 7777	Japan	+81 044 844 8180
EMEA/South Africa	+800 0440 5100	Australia	+61 2 9554 2695
EMEA (Toll)	+31 73 624 6999	New Zealand	+64 (0) 9 634 4580
India (Toll-Free)	+800 440 5100		

[te.com/983](http://te.com/983)

AMP, AGASTAT, CII, DEUTSCH, HARTMAN, KILOVAC, LL ROWE, MICRODOT, NANONICS, POLAMCO, Raychem, SEACON, TE, TE Connectivity and the TE connectivity (logo) are trademarks of the TE Connectivity Ltd. family of companies. Other products, logos, and company names mentioned herein may be trademarks of their respective owners.

While TE Connectivity (TE) has made every reasonable effort to ensure the accuracy of the information herein, nothing herein constitutes any guarantee that such information is error-free, or any other representation, warranty or guarantee that the information is accurate, correct, reliable or current. The TE entity issuing this publication reserves the right to make any adjustments to the information contained herein at any time without notice. All implied warranties regarding the information contained herein, including, but not limited to, any implied warranties of merchantability or fitness for a particular purpose are expressly disclaimed. The dimensions herein are for reference purposes only and are subject to change without notice. Specifications are subject to change without notice.

Consult TE for the latest dimensions and design specifications.

© 2016 TE Connectivity Ltd. family of companies All Rights Reserved.

1-1773903-5 12/16