

CONNECTORS



- Snap-in locking system
- 3 – 5 contacts
- Degree of protection IP40
- Solder termination
- Moulded versions
- Easy assembly



Description	Drawing	Contacts	Cable outlet	Ordering-No.
Male cable connector without strain relief		3		09 9747 00 03
		4	3,6 mm	09 9767 00 04
		5		09 9789 00 05



Male cable connector with strain relief		3	2,5–4 mm	09 9747 70 03
			3,5–5 mm	09 9747 71 03
		4	2,5–4 mm	09 9767 70 04
			3,5–5 mm	09 9767 71 04
		5	3,5–5 mm	09 9789 71 05



Female cable connector without strain relief		3		09 9748 00 03
		4	3,6 mm	09 9764 00 04
		5		09 9790 00 05



Female cable connector with strain relief		3	2,5–4 mm	09 9748 70 03
			3,5–5 mm	09 9748 71 03
		4	2,5–4 mm	09 9764 70 04
			3,5–5 mm	09 9764 71 04
		5	3,5–5 mm	09 9790 71 05



Specifications

Contacts	3	4	5
Wire gauge	max. 0,25 mm ² (max. AWG 24)		
Mechanical operation	> 100 Mating cycles		
Temperature range	– 25 °C / + 70 °C		
Rated voltage	60 V		
Pollution degree	1		
Rated current (40°C)	3 A		
Contact plating	Au (Gold)		
Material of housing	PA		

Description

Male cable connector, moulded



Drawing

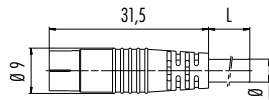

Contacts

Cable length, PVC

Ordering-No.

3 x 0,25	2 m	79 9001 12 03
	5 m	79 9001 15 03
4 x 0,25	2 m	79 9003 12 04
	5 m	79 9003 15 04
5 x 0,25	2 m	—
	5 m	79 9005 15 05

Female cable connector, moulded

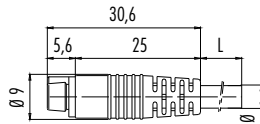

3 x 0,25	2 m	79 9002 12 03
	5 m	79 9002 15 03
4 x 0,25	2 m	79 9004 12 04
	5 m	79 9004 15 04
5 x 0,25	2 m	79 9006 12 05
	5 m	79 9006 15 05

Male panel mount connector, solder termination/dip-solder termination

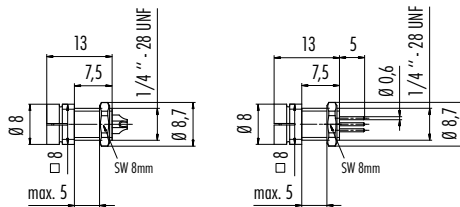

Contacts	Cable length	Solder termination	Dip-Solder termination
3	—	09 9749 30 03	09 9749 20 03
4	—	09 9765 30 04	09 9765 20 04
5	—	09 9791 30 05	09 9791 20 05

Female panel mount connector, solder termination/dip-solder termination

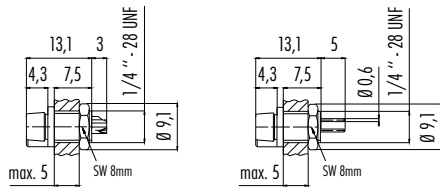

3	—	09 9750 30 03	09 9750 20 03
4	—	09 9766 30 04	09 9766 20 04
5	—	09 9792 30 05	09 9792 20 05

Component part drawing

Cable connector without strain relief

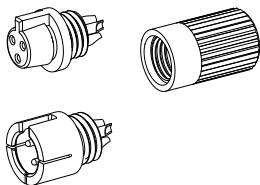

Female insert
Male insert
Sleeve

Cable connector with strain relief

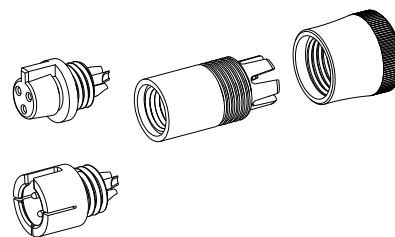

Female insert
Male insert
Pinch ring
Pressing screw

Contact arrangements male insert (mating side)

3 contacts 4 contacts 5 contacts



Contact arrangements female insert (mating side)

3 contacts 4 contacts 5 contacts

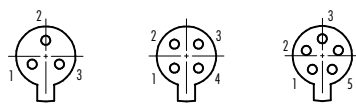

Panel cut out



Colour of wire, moulded cable connectors

- 1 brown
- 2 white
- 3 blue
- 4 black
- 5 grey

- Snap-in locking system
- 3 – 8 contacts
- Degree of protection IP67
- Solder termination
- Diameter 11,5 mm



Description

Male cable connector

Drawing

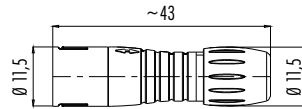

Contacts Cable outlet

Contacts	Cable outlet	Black
3	3–5 mm	99 9205 00 03
4		99 9209 00 04
5		99 9213 00 05
8		99 9225 00 08

Male cable connector, red, blue, green



Red Blue Green

3	3–5 mm	99 9205 050 03	99 9205 060 03	99 9205 070 03
4		99 9209 050 04	99 9209 060 04	99 9209 070 04
5		99 9213 050 05	99 9213 060 05	99 9213 070 05
8		99 9225 050 08	99 9225 060 08	99 9225 070 08

Female cable connector

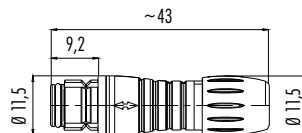

Black

3	3–5 mm	99 9206 00 03
4		99 9210 00 04
5		99 9214 00 05
8		99 9226 00 08

Female cable connector, red, blue, green



Red Blue Green

3	3–5 mm	99 9206 050 03	99 9206 060 03	99 9206 070 03
4		99 9210 050 04	99 9210 060 04	99 9210 070 04
5		99 9214 050 05	99 9214 060 05	99 9214 070 05
8		99 9226 050 08	99 9226 060 08	99 9226 070 08

Specifications

Contacts	3	4	5	8
Wire gauge	max. 0,25 mm ² (max. AWG 24)			
Mechanical operation	> 500 Mating cycles			
Temperature range	– 25 °C / + 85 °C			
Rated voltage	125 V		63 V	
Pollution degree	2			
Rated current (40°C)	3 A	2,5 A	2 A	1 A
Contact plating	Au (Gold)			
Material of housing	PA			