

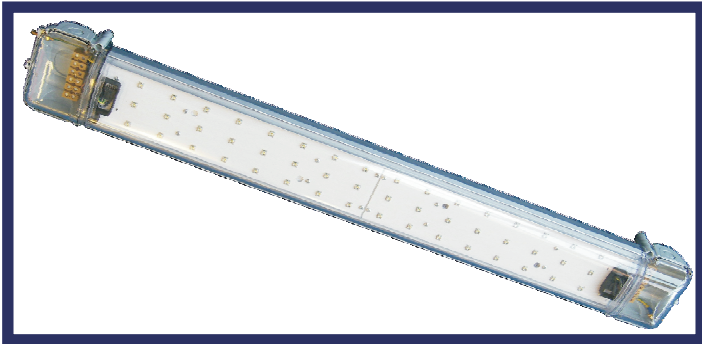

# LEDPAK<sup>®</sup>

## Industrial and Commercial LED Lighting Units



### FEATURES / BENEFITS

#### FEATURES

- ▲ Double IP 65 rated - Cable termination independent of main luminaire.
- ▲ Through-wired as standard.
- ▲ 5 conduit entry points per end.
- ▲ Direct external fixings without opening - 4 screw mounts or or channel fixing kit (supplied).
- ▲ Self-retaining screws in termination covers.
- ▲ 3-phase through wiring to special order.

#### BENEFITS

- ▲ Long, maintenance-free life - in excess of 50,000 hrs.
- ▲ 36W or 72W versions using latest high-power LED technology.
- ▲ High-reliability drive electronics.
- ▲ Robust design - resistant to shock and vibration.
- ▲ Instant light output - no warm-up time.
- ▲ Excellent performance in cold locations.

### ELECTRICAL SPECIFICATION

#### Input

- ▲ Voltage (V<sub>in</sub>) 110/230Vac - 50/60Hz
- ▲ Power Consumption LEDPAK-24 - 36W  
LEDPAK-48 - 72W
- ▲ Power Factor (λ) >0.95
- ▲ Power Supply Protection Over-Temp. Cut Off  
Open-Circuit Cut Off

#### Output

- ▲ No. Of LEDs (350mA) LEDPAK-24 - 24 LEDs  
LEDPAK-48 - 48 LEDs
- ▲ Output Control Constant Current
- ▲ LifeSaver<sup>®</sup> LED Protection Thermistor Circuit

#### Connection

- ▲ Brown Live
- ▲ Blue Neutral
- ▲ Green/Yellow Mains Earth
- ▲ Earth Bonding M5 Brass Stud
- ▲ Through Cable 2.5mm<sup>2</sup>

### APPLICATIONS

- ▲ Road, rail and pedestrian tunnels.
- ▲ Water treatment works.
- ▲ Cold storage facilities.
- ▲ Marine and ship decks.
- ▲ General area lighting.
- ▲ Plant rooms.
- ▲ Food processing areas.
- ▲ Clean rooms.

### ENVIRONMENTAL

- ▲ Operating Ambient Temp. -20°C to +50°C
- ▲ Operating Case Temperature -20°C to +85°C
- ▲ Ambient Storage Temp. -40°C to +100°C
- ▲ Max. Operating Humidity 85%
- ▲ Ingress Protection IP 65

### MECHANICAL SPECIFICATION

- ▲ Size LEDPAK-24 663mm x 138mm 88mm  
LEDPAK-48 1063mm x 138mm x 88mm  
(Earth Studs protrude 10mm at either end)
- ▲ Casing 6060-T6 Aluminium Extrusion and Polycarbonate Mouldings
- ▲ Finish Anodised Aluminium and Clear/Coloured Polycarbonate
- ▲ Internal Fully Sealed to IP 65
- ▲ Fixing Method 4 x M6 Screws or 4 x No 8 Screws or Slot Bolts (provided)

Dialight-Lumidrives reserves the right to make changes at any time in order to supply the best product possible.

## FIXING / WIRING DETAIL

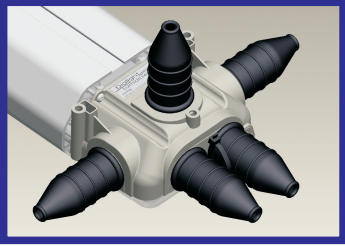

**End Assembly**  
Available Entry Points

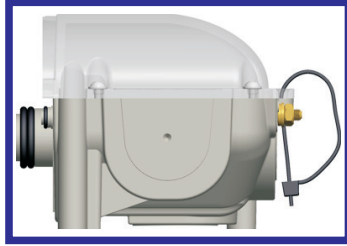

**End Assembly**  
Drill-Out Location

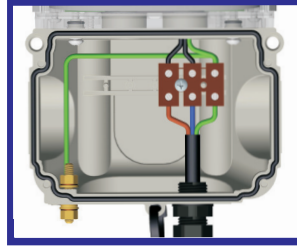

**Wiring Compartment**

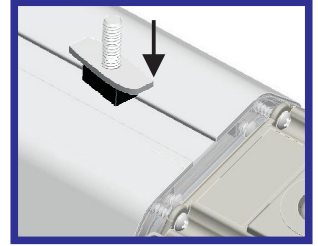

**Slot-Bolt Assembly**

## DIMENSIONS

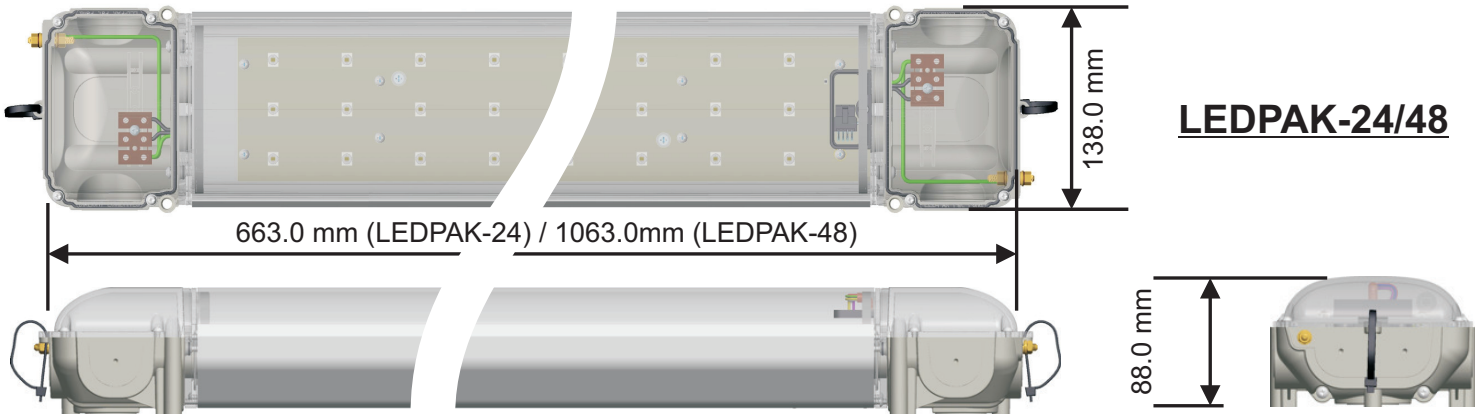

## PHOTOMETRICS

Photometric Data in the form of IES files are available. Consult factory.

## PART NUMBER

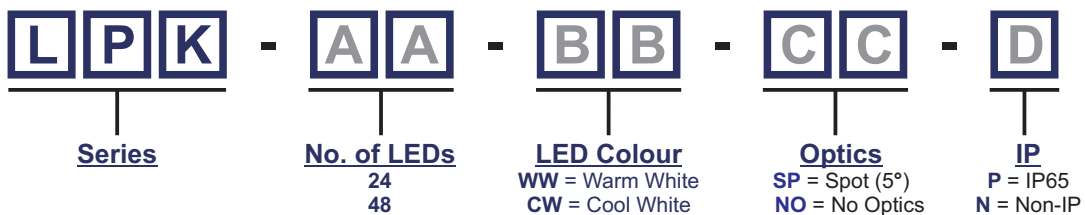

**Dialight Europe Ltd**  
Exning Road - Newmarket - Suffolk - CB8 0AX - UK  
Tel: +44 (0) 1638 665161 - Fax: +44 (0)1638 660718 - [www.dialightlumidrives.com](http://www.dialightlumidrives.com)



**Dialight Corporation**  
1501 Route 34 South - Farmingdale - NJ - 07727 - USA  
Tel: (1) 732 919 3119 - Fax: (1) 732 751 5778 - [www.dialight.com](http://www.dialight.com)



A55-LPK-24-48-DT