

3 Contact Row Signal Connectors

HE 808 PCB CONNECTORS QUALIFIED
ESA/SCC 3401039 B

- Equipped with 0.50 mm contact
- High density interconnection
- Up to 144 signal contacts / 3 rows
- 2.54 mm contact spacing in each row and 1.905mm row-to-row spacing
- Low contact insertion
- Low contact resistance
- Polarization by guiding or locking devices
- 5000 mating and unmating cycles

Technical Characteristics

MATERIAL		INSULATION RESISTANCE	> 10 ⁴ MW (500 Vcc)
Materials moulding	Glass fibre filled diallyl - phtalate	CONTACT RESISTANCE	# 8 mW
Contacts	Brass or bronze	TEMPERATURE RANGE	-55 °C, +125 °C
Guides - coding styles - screws	Stainless steel or nickel, plated brass or ARCAP	CONTACTS	HYPERTAC® type Ø 0,50 mm
PLATING		PITCH	2,54 mm contact spacing 1.905 mm row-to-row spacing
Pin	1.27 µm gold/1.27µmNi (min)	GUIDING	By two outside guides (2 guiding styles) and one central guide (3 guiding styles)
Socket body	0.25 µm gold/1.27µmNi (min)	KEYING	By rotating of outside polarised guides (36 keyings possible)
Socket wires	1.27 µm gold/0.20µmNi (min)	MASS & POWER CONTACTS	HYPERTAC® can be used instead of outside guides as mass contact. Contact sales
Guides	Ni		
DIELECTRIC WITHSTANDING VOLTAGE	800 Vrms		
CURRENT RATING	3 A Max (25 °C)		

KMC - Plug & receptacle polarity

Plugs

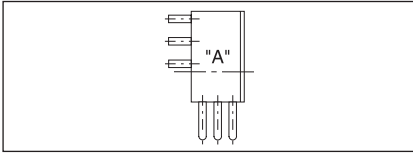

Standard version : One part moulding type "A"
fitted with male contacts
■ 90° trough board solder.

Receptacles

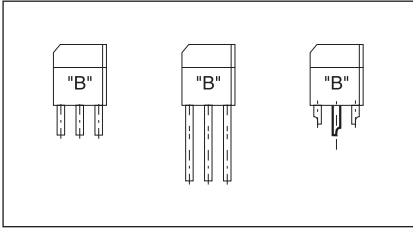

Standard version : Two part moulding type "B"
fitted with female contacts
■ through board solder-straight
■ wire wrap type (2 and 3 wrapping levels)
■ solder bucket.
(style identical to plug type "B" but printed as receptacle).

Plug & Receptacle terminations

Plug

Through board
solder 90°
length : 3 mm
(standard)

Ref: **10**

*Ref : **10**

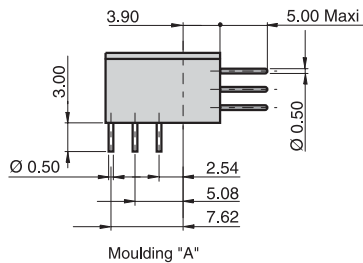

Moulding "A"

IMPORTANT : Termination positions different see board preparation details

Saver

Female/male

Ref: **91**

*Ref : **91**

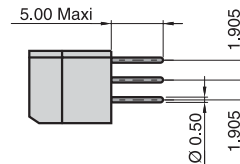

Receptacles

Through board
solder
straight

Ref: **30** length 4.50 mm

*Ref : **30**

Ref: **31** length 5.6mm

*Ref : **31**

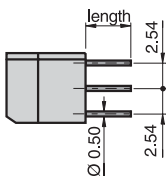

Solder for wire
solder bucket
(AWG 26 Maxi)

Ref: **40**

*Ref : **40**

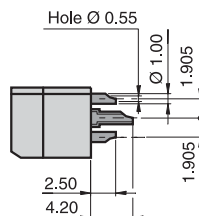

Wire wrap
2 wrapping
level

Ref: **50**

*Ref : **50**

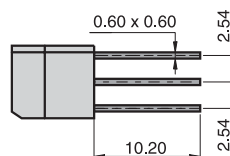

Wire wrap
3 wrapping
level

Ref: **51**

*Ref : **51**

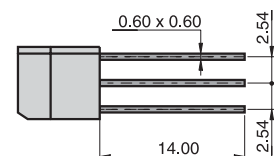

Dimensions are in mm

KMC - Plug & receptacle dimensions

26 to 98 Contacts

144 Contacts

One part moulding "A"

Bent male plugs KMC ... 13 10 ...

Bent male receptacles KMC ... 23 10 ...

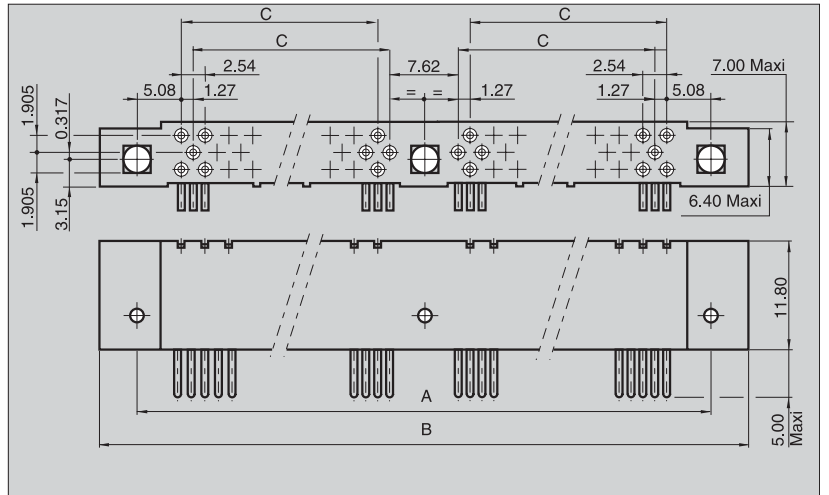
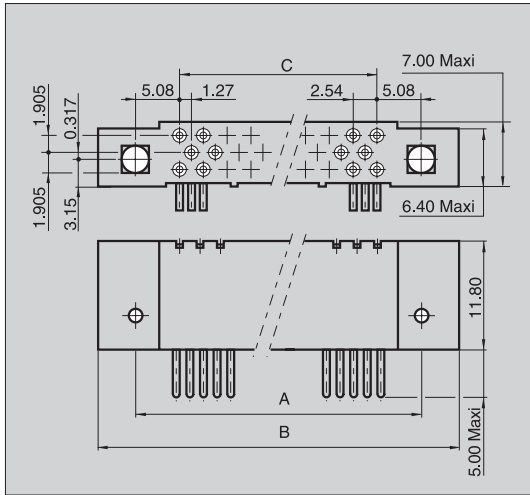

Two part moulding "B"

Female or male receptacles KMC ... 2 ...

Female or male plugs KMC ... 1 ...

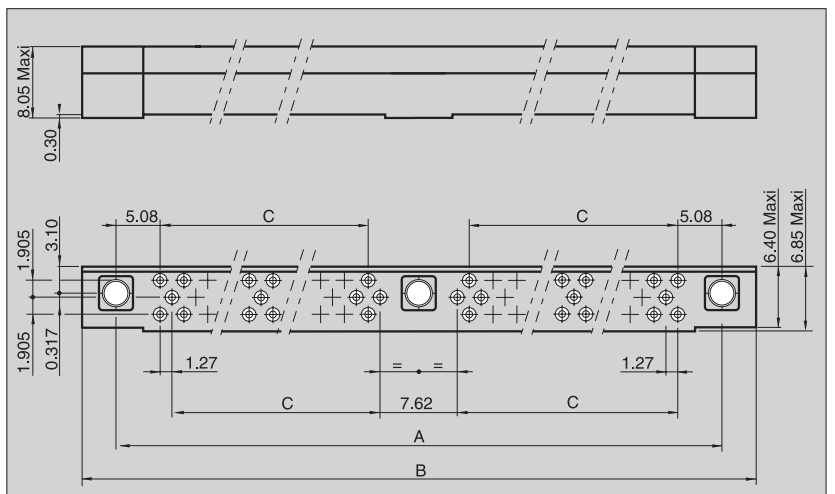
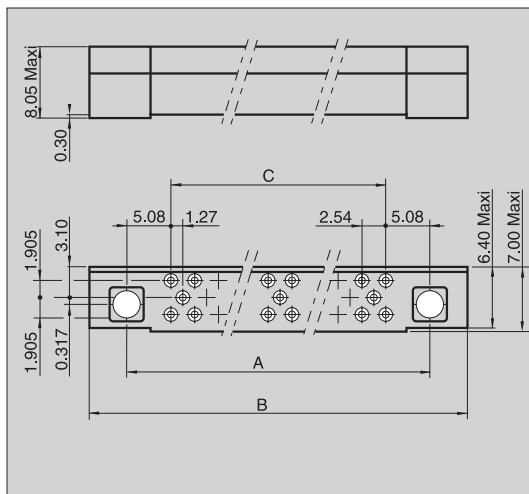

No. of contacts	26	44	62	80	98	144
A	30.48	45.72	60.96	76.20	91.44	137.16
B Maxi	38.50	53.70	69	84.20	99.50	145.20
C	20.32	35.56	50.80	66.04	81.28	58.42

Dimensions are in mm

KMC - Plug & receptacle guiding styles

Male

Polarised guide
(mounting A)
Ref: **110**
Ref : **110**

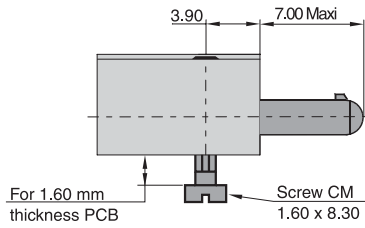

Unpolarised central guide
(KMC 144)
Ref: **110**
Ref : **110**

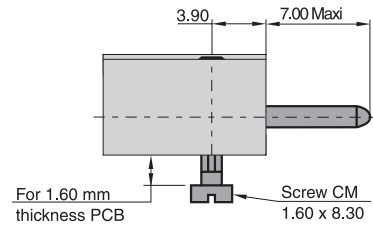

Female

Polarised guide
(moulding B)
*Ref: **121**
Ref: **143**
* Ref. = Ref. HYPERTAC

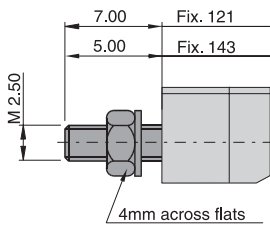

Unpolarised central guide
(KMC 144)
*Ref: **121**
Ref: **143**
* Ref. = Ref. HYPERTAC

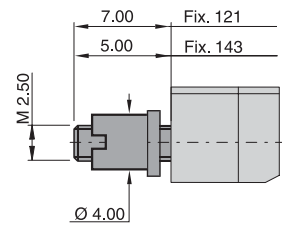

Female * Male

Unpolarised guide
(moulding B)
Ref: **703**
Ref : **703**

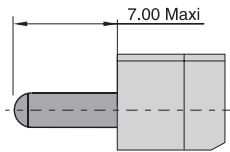

Central guide
(KMC 144)
Ref: **703**
Ref : **703**

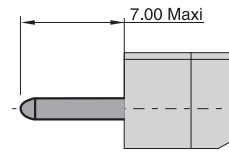

Others plug & receptacle locking style no presented

- Ref: **201** Ref: **202** Ref: **204** Ref: **206**
Ref : **201** Ref : **202** Ref : **204** Ref : **206**

KMC - Board preparation details

26 to 98 Contacts

144 Contacts

Mother Board: Two part moulding "B" -
 Female or male, plugs or receptacles, straight solder terminations 30 or 31
 Guiding styles : 121

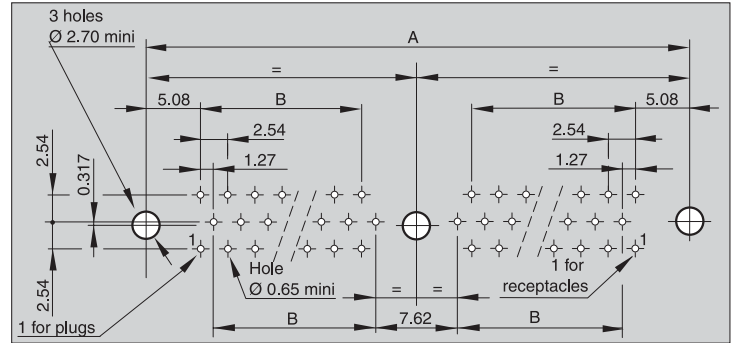
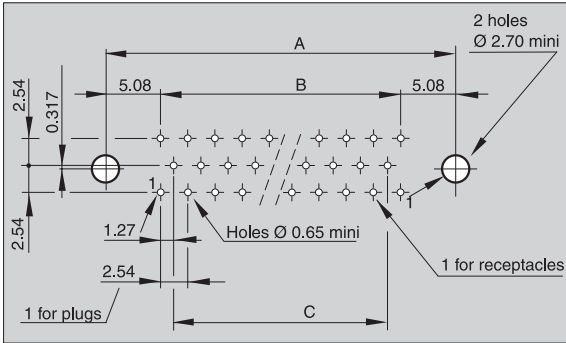

Daughter Board : Two part moulding "B" -
 Female or male, plugs or receptacles 90° terminations
 Guiding styles : 153 - 154 - 155 - 156

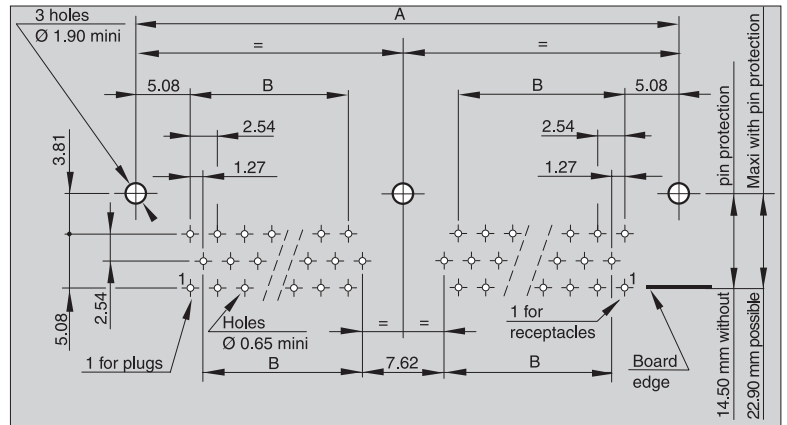
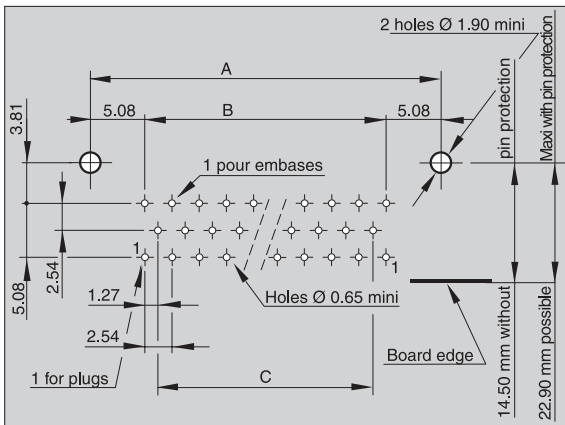

Daughter Board : Two part moulding "B" -
 Female or male, plugs or receptacles 90° terminations
 Guiding styles : 124 - 133

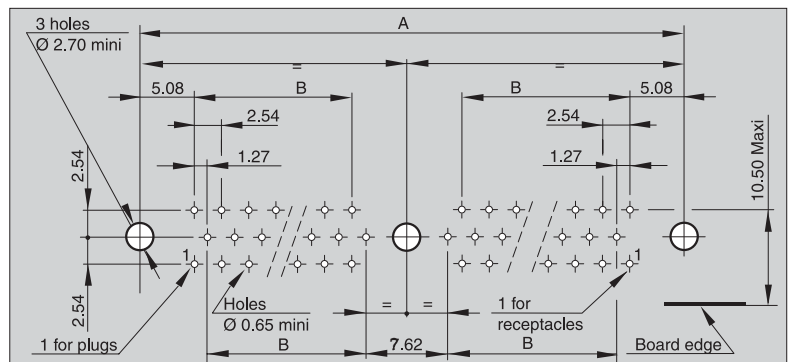
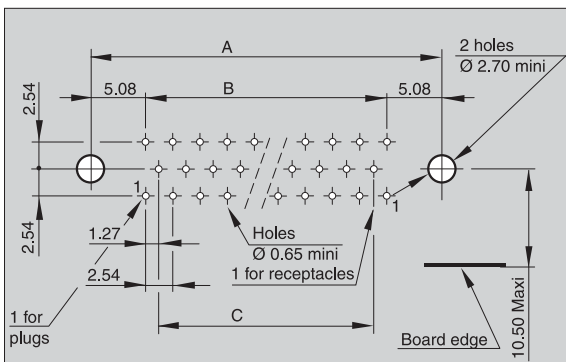

No. of contacts	26	44	62	80	98	144
A	30.48	45.72	60.96	76.20	91.44	137.16
B	20.32	35.56	50.80	66.04	81.28	58.42
C	17.78	33.02	48.26	63.50	78.74	-
D	25.90	41.20	56.40	71.60	86.90	63.60

Dimensions are in mm

KMC

26 to 98 Contacts

Daughter Board : One part moulding "A" - Male plugs or receptacles 90° terminations
Guiding styles : 110 - 125 - 191

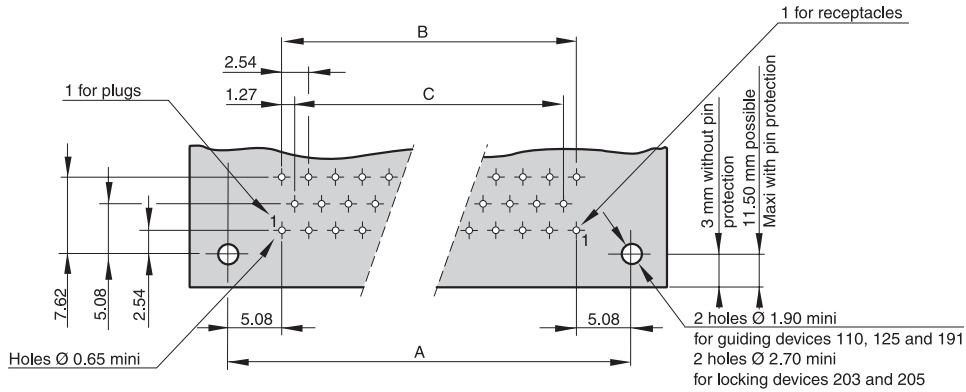

144 Contacts

Daughter Board : One part moulding "A" - Male plugs or receptacles 90° terminations
Guiding styles : 110 - 125 - 191 -

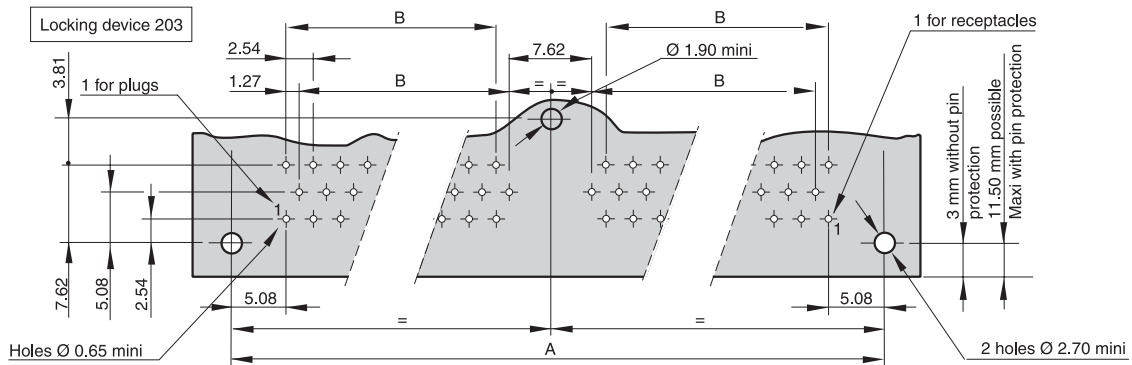
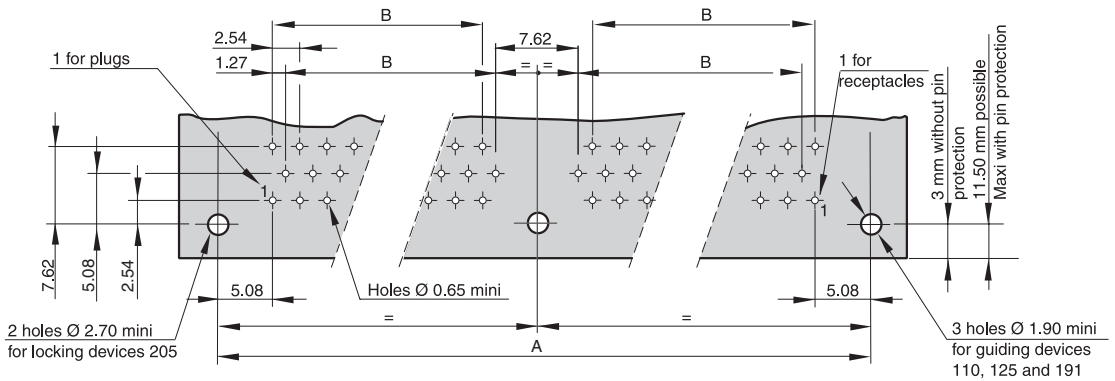

No. of contacts	26	44	62	80	98	144
A	30.48	45.72	60.96	76.20	91.44	137.16
B	20.32	35.56	50.80	66.04	81.28	58.42
C	17.78	33.02	48.26	63.50	78.74	-

Dimensions are in mm

KMC

26 to 98 Contacts

144 Contacts

Mother Board: Two part moulding "B" - plugs or receptacles 90° terminations
Guiding styles : 153 - 154 - 155 - 156

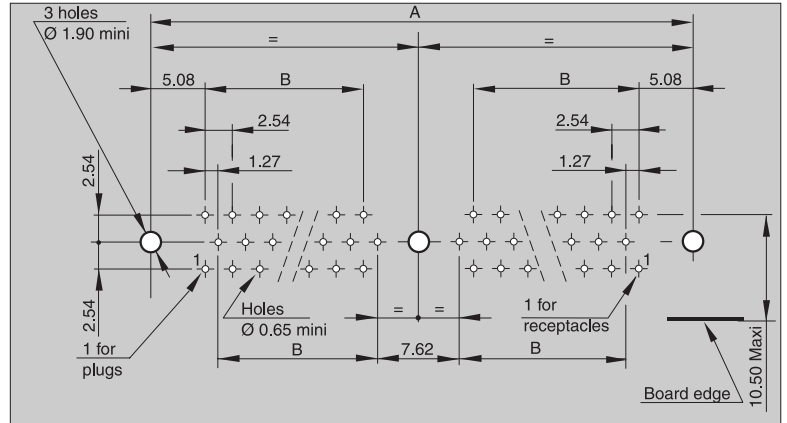
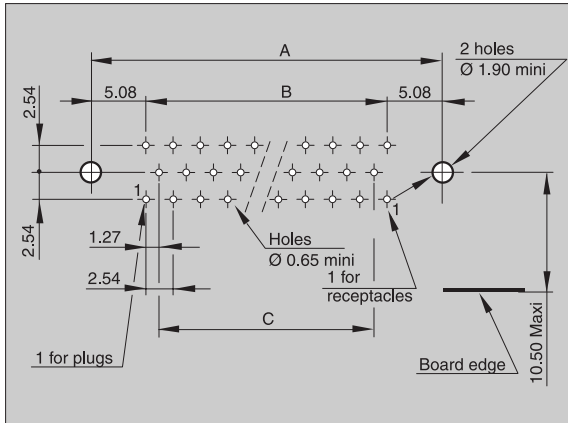

Daughter Board : Two part moulding "B" -
Female or male, plugs or receptacles 90° terminations 40 - 50 - 51
Guiding styles : 111 - 112 - 121 - 130 - 143 - 190 - (Fixed Mounting)
Guiding styles : 113 - 123 - 128 - (Float Mounting)

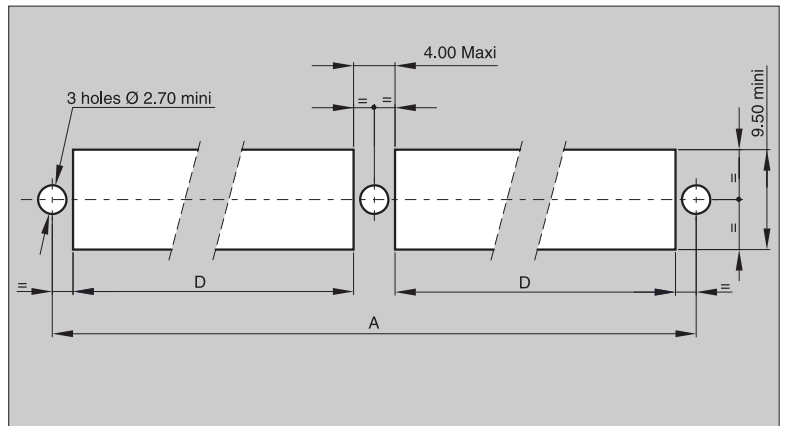
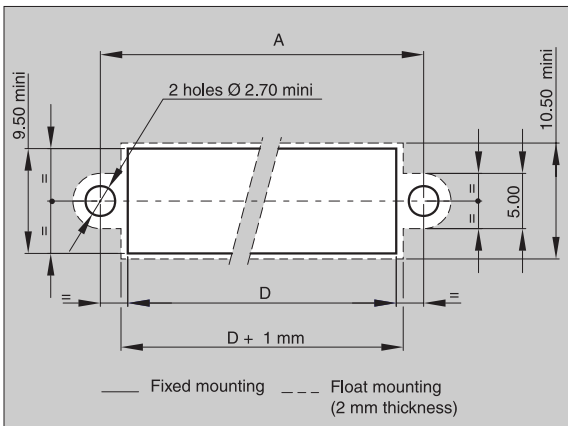

No. of contacts	26	44	62	80	98	144
A	30.48	45.72	60.96	76.20	91.44	137.16
B	20.32	35.56	50.80	66.04	81.28	58.42
C	17.78	33.02	48.26	63.50	78.74	-
D	25.90	41.20	56.40	71.60	86.90	63.60