

CONNECTOR DESIGNATOR

A

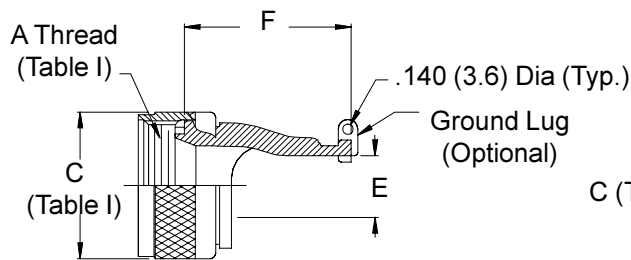

**STRAIGHT
ROTATABLE COUPLING**

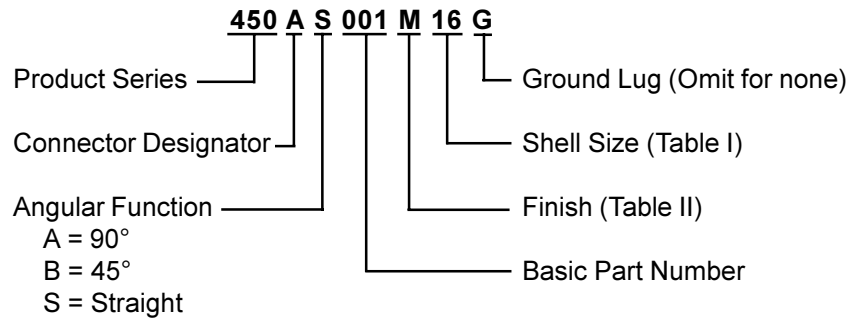
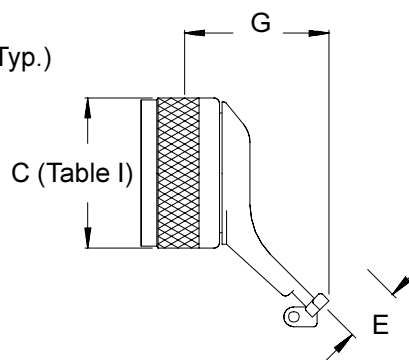

**45°
ROTATABLE COUPLING**

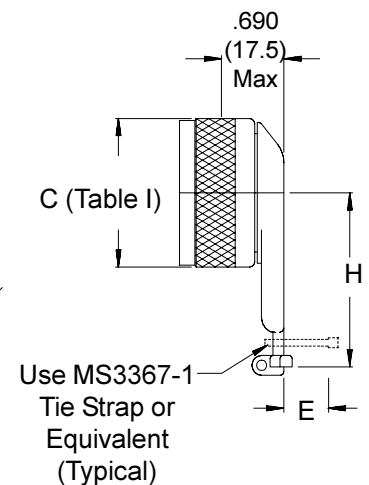

**90°
ROTATABLE COUPLING**

See inside back cover fold-out or pages 13 and 14 for Tables I and II.

TABLE III					
Shell Size	E Cable Entry	F Max	G Max	H Max	
08	.260 (6.6)	.866 (22.0)	1.066 (27.1)	.890 (22.6)	
10	.365 (9.3)	.866 (22.0)	1.066 (27.1)	.950 (24.1)	
12	.501 (12.7)	.926 (23.5)	1.066 (27.1)	1.010 (25.7)	
14	.575 (14.6)	1.106 (28.1)	1.188 (30.2)	1.330 (33.8)	
16	.700 (17.8)	1.106 (28.1)	1.226 (31.1)	1.390 (35.3)	
18	.779 (19.8)	1.176 (29.9)	1.226 (31.1)	1.460 (37.1)	
20	.904 (23.0)	1.306 (33.2)	1.226 (31.1)	1.510 (38.4)	
22	1.029 (26.1)	1.426 (36.2)	1.226 (31.1)	1.510 (38.4)	
24	1.144 (29.1)	1.556 (39.5)	1.226 (31.1)	1.640 (41.7)	

1. Cable Entry is defined as the accommodation entry for the wire bundle or cable. Dimensions are not intended for inspection criteria.
2. Metric dimensions (mm) are indicated in parentheses.

Series 45 Qwik-Ty® Strain Reliefs



CONNECTOR DESIGNATOR

D

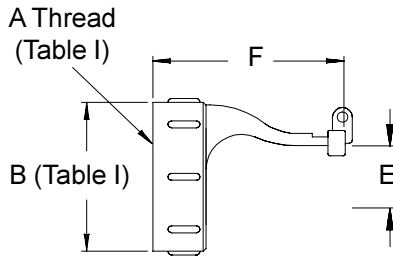
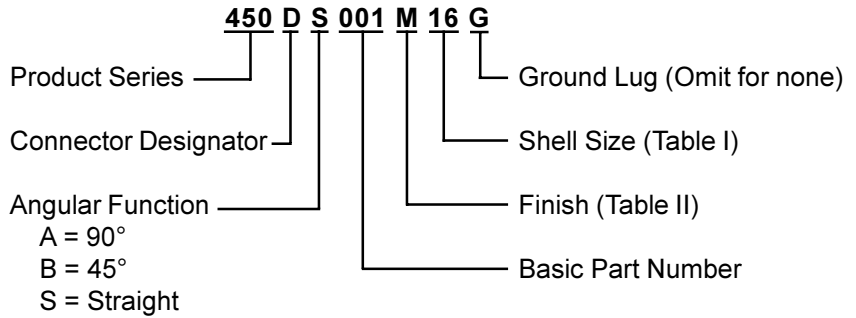

**STRAIGHT
DIRECT COUPLING**

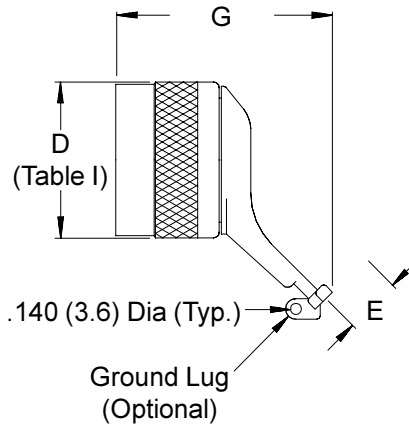

**45°
ROTATABLE COUPLING**

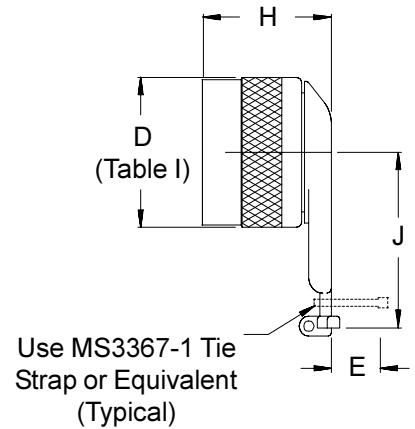

**90°
ROTATABLE COUPLING**

See inside back cover fold-out or pages 13 and 14 for Tables I and II.

TABLE III							
Shell Size	E Cable Entry	F Max	G Max	H Max	J Max		
08	.275 (7.0)	1.400 (35.6)	1.850 (47.0)	1.240 (31.5)	.880 (22.4)		
10	.402 (10.2)	1.400 (35.6)	1.850 (47.0)	1.240 (31.5)	.940 (23.9)		
12	.516 (13.1)	1.400 (35.6)	1.850 (47.0)	1.240 (31.5)	1.000 (25.4)		
14	.651 (16.5)	1.610 (40.9)	2.350 (59.7)	1.230 (31.2)	1.320 (33.5)		
16	.766 (19.5)	1.610 (40.9)	2.350 (59.7)	1.230 (31.2)	1.380 (35.1)		
18	.872 (22.1)	1.610 (40.9)	2.440 (62.0)	1.260 (32.0)	1.460 (37.1)		
20	.997 (25.3)	1.680 (42.7)	2.510 (63.8)	1.260 (32.0)	1.510 (38.4)		
22	1.125 (28.6)	1.680 (42.7)	2.510 (63.8)	1.260 (32.0)	1.560 (39.6)		
24	1.247 (31.7)	1.770 (45.0)	2.650 (67.3)	1.260 (32.0)	1.630 (41.4)		

1. Cable Entry is defined as the accommodation entry for the wire bundle or cable. Dimensions are not intended for inspection criteria.
2. Metric dimensions (mm) are indicated in parentheses.

CONNECTOR DESIGNATOR

E

450 E S 001 M 16 G

Product Series — 450
 Connector Designator — E
 Angular Function — S
 A = 90°, B = 45°
 S = Straight

Ground Lug (Omit for none)
 Shell Size (Table I)
 Finish (Table II)
 Basic Part Number
 001, 002

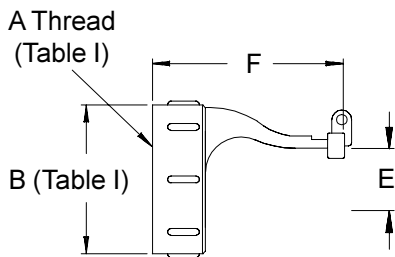

450ES001
STRAIGHT DIRECT COUPLING

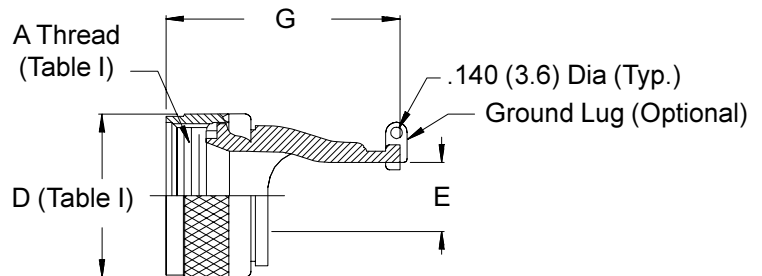

450ES002
STRAIGHT ROTATABLE COUPLING

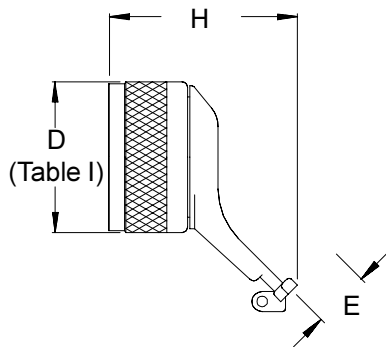

450EB001
45° ROTATABLE COUPLING

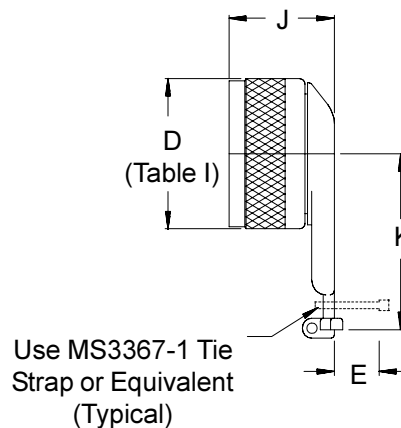

450EA001
90° ROTATABLE COUPLING

See inside back cover fold-out or pages 13 and 14 for Tables I and II.

TABLE III						
Shell Size	E Cable Entry	F Max	G Max	H Max	J Max	K Max
08	.355 (9.0)	1.060 (26.9)	1.350 (34.3)	1.320 (33.5)	.880 (22.4)	.940 (23.9)
10	.465 (11.8)	1.060 (26.9)	1.410 (35.8)	1.440 (36.6)	.880 (22.4)	1.000 (25.4)
12	.625 (15.9)	1.060 (26.9)	1.600 (40.6)	1.580 (40.1)	.880 (22.4)	1.320 (33.5)
14	.695 (17.7)	1.310 (33.3)	1.600 (40.6)	1.600 (40.6)	.880 (22.4)	1.380 (35.1)
16	.810 (20.6)	1.310 (33.3)	1.650 (41.9)	1.600 (40.6)	1.020 (25.9)	1.460 (37.1)
18	.942 (23.9)	1.310 (33.3)	1.780 (45.2)	1.630 (41.4)	1.020 (25.9)	1.510 (38.4)
20	1.079 (27.4)	1.310 (33.3)	1.900 (48.3)	1.630 (41.4)	.970 (24.6)	1.560 (39.6)
22	1.079 (27.4)	1.310 (33.3)	2.030 (51.6)	1.630 (41.4)	.970 (24.6)	1.560 (39.6)
24	1.300 (33.0)	1.310 (33.3)	2.060 (52.3)	1.630 (41.4)	.880 (22.4)	1.630 (41.4)

1. Cable Entry is defined as the accommodation entry for the wire bundle or cable. Dimensions are not intended for inspection criteria.
2. Metric dimensions (mm) are indicated in parentheses.

Series 45 Qwik-Ty® Strain Reliefs



CONNECTOR DESIGNATOR

F

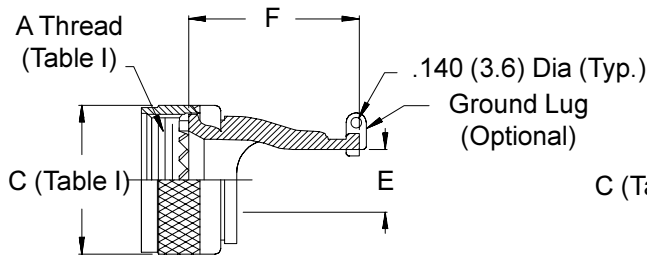
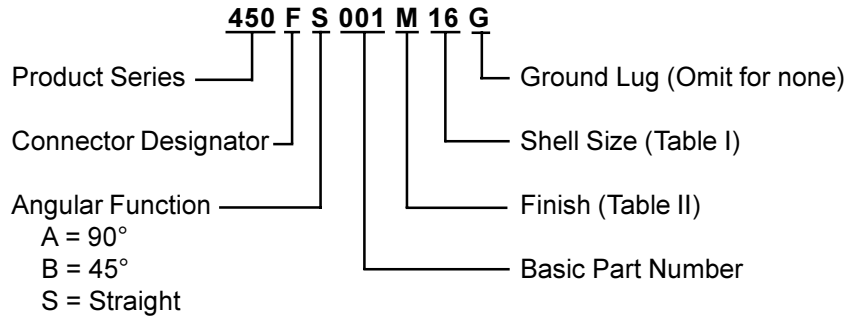

**STRAIGHT
ROTATABLE COUPLING**

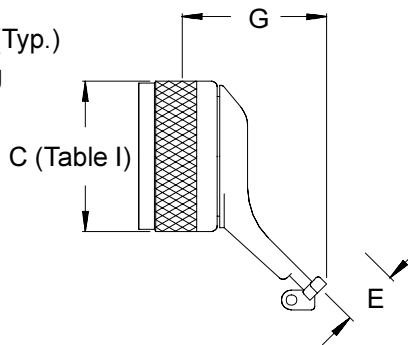

**45°
ROTATABLE COUPLING**

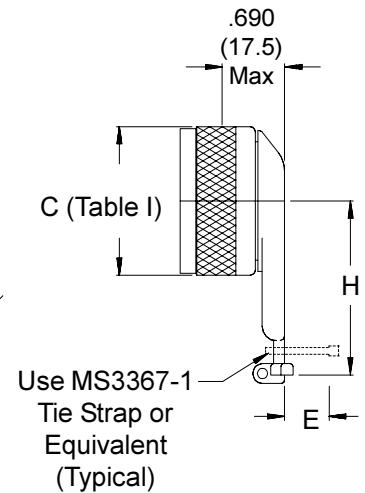

**90°
ROTATABLE COUPLING**

See inside back cover fold-out or pages 13 and 14 for Tables I and II.

TABLE III								
Shell Size	E Cable Entry		F Max		G Max		H Max	
08	.264	(6.7)	.866	(22.0)	1.066	(27.1)	.890	(22.6)
10	.392	(10.0)	.866	(22.0)	1.066	(27.1)	.950	(24.1)
12	.506	(12.9)	.926	(23.5)	1.066	(27.1)	1.010	(25.7)
14	.631	(16.0)	1.106	(28.1)	1.188	(30.2)	1.330	(33.8)
16	.756	(19.2)	1.106	(28.1)	1.226	(31.1)	1.390	(35.3)
18	.845	(21.5)	1.176	(29.9)	1.226	(31.1)	1.460	(37.1)
20	.970	(24.6)	1.306	(33.2)	1.226	(31.1)	1.510	(38.4)
22	1.095	(27.8)	1.426	(36.2)	1.226	(31.1)	1.510	(38.4)
24	1.220	(31.0)	1.556	(39.5)	1.226	(31.1)	1.640	(41.7)

1. Cable Entry is defined as the accomodation entry for the wire bundle or cable. Dimensions are not intended for inspection criteria.
2. Metric dimensions (mm) are indicated in parentheses.

CONNECTOR DESIGNATOR

H

Product Series — 450 H S 001 M 17 G

Connector Designator —

Angular Function —
A = 90°
B = 45°
S = Straight

Ground Lug (Omit for none)

Shell Size (Table I)

Finish (Table II)

Basic Part Number

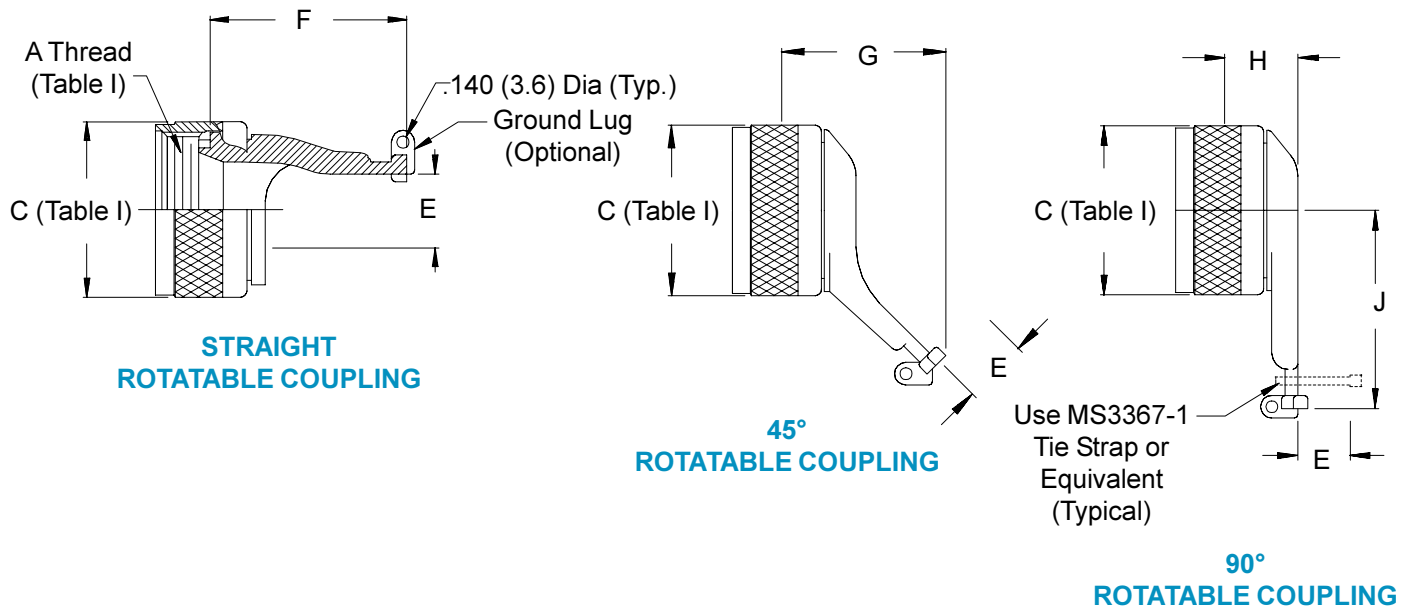

See inside back cover fold-out or pages 13 and 14 for Tables I and II.

Shell Size	E Cable Entry	F Max	G Max	H Max	J Max
09	.250 (6.4)	.866 (22.0)	1.066 (27.1)	.464 (11.8)	.889 (22.6)
11	.382 (9.7)	.866 (22.0)	1.066 (27.1)	.496 (12.6)	.948 (24.1)
13	.500 (12.7)	.925 (23.5)	1.066 (27.1)	.535 (13.6)	1.070 (27.2)
15	.630 (16.0)	1.102 (28.0)	1.188 (30.2)	.574 (14.6)	1.330 (33.8)
17	.750 (19.1)	1.102 (28.0)	1.224 (31.1)	.590 (15.0)	1.389 (35.3)
19	.838 (21.3)	1.177 (29.9)	1.224 (31.1)	.685 (17.4)	1.480 (37.6)
21	.968 (24.6)	1.307 (33.2)	1.224 (31.1)	.685 (17.4)	1.661 (42.2)
23	1.090 (27.7)	1.425 (36.2)	1.224 (31.1)	.716 (18.2)	1.850 (47.0)
25	1.220 (31.0)	1.555 (39.5)	1.224 (31.1)	.755 (19.2)	1.909 (48.5)

1. Cable Entry is defined as the accommodation entry for the wire bundle or cable. Dimensions are not intended for inspection criteria.
2. Metric dimensions (mm) are indicated in parentheses.

Series 45 Qwik-Ty® Strain Reliefs



CONNECTOR DESIGNATOR

J

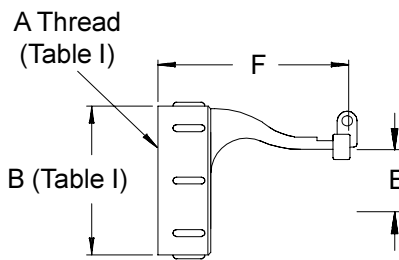
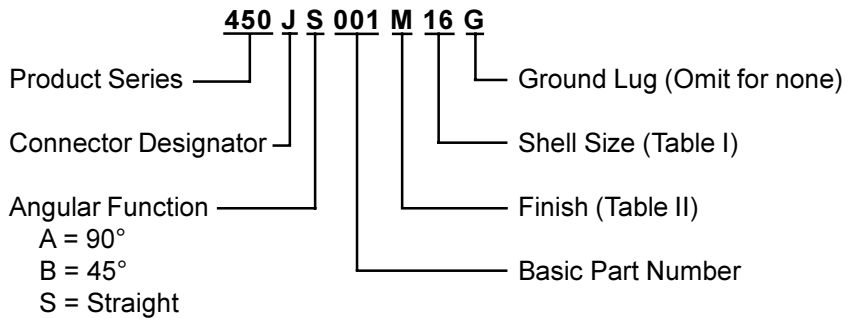

**STRAIGHT
DIRECT COUPLING**

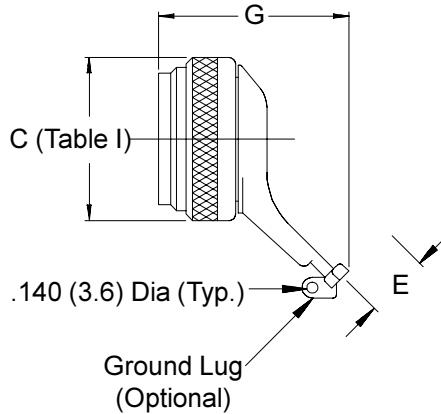

**45°
ROTATABLE COUPLING**

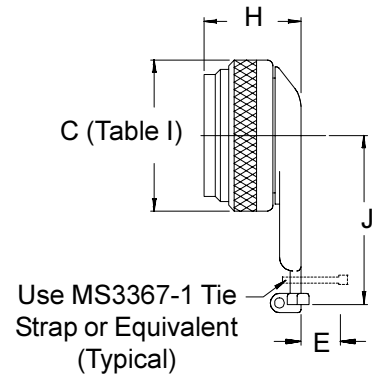

**90°
ROTATABLE COUPLING**

See inside back cover fold-out or pages 13 and 14 for Tables I and II.

TABLE III						
Shell Size	E Cable Entry	F Max	G Max	H Max	J Max	
08	.375 (9.5)	1.250 (31.8)	1.630 (41.4)	.750 (19.1)	.940 (23.9)	
10	.500 (12.7)	1.250 (31.8)	1.670 (42.4)	.750 (19.1)	1.000 (25.4)	
14	.750 (19.1)	1.500 (38.1)	2.200 (55.9)	.750 (19.1)	1.380 (35.1)	
16	.875 (22.2)	1.500 (38.1)	2.270 (57.7)	.780 (19.8)	1.460 (37.1)	
18	1.000 (25.4)	1.500 (38.1)	2.330 (59.2)	.780 (19.8)	1.510 (38.4)	
20	1.125 (28.6)	1.500 (38.1)	2.410 (61.2)	.810 (20.6)	1.560 (39.6)	
22	1.250 (31.8)	1.500 (38.1)	2.550 (64.8)	.810 (20.6)	1.630 (41.4)	
24	1.375 (34.9)	1.500 (38.1)	2.590 (65.8)	.810 (20.6)	1.710 (43.4)	

1. Cable Entry is defined as the accommodation entry for the wire bundle or cable. Dimensions are not intended for inspection criteria.
2. Metric dimensions (mm) are indicated in parentheses.

CONNECTOR DESIGNATOR

L

Product Series — **450** L **S** 001 **M** 16 **G**

Connector Designator — **L**

Angular Function — **S**

Ground Lug (Omit for none) — **G**

Shell Size (Table I) — **16**

Finish (Table II) — **M**

Basic Part Number — **001**

A = 90°
B = 45°
S = Straight

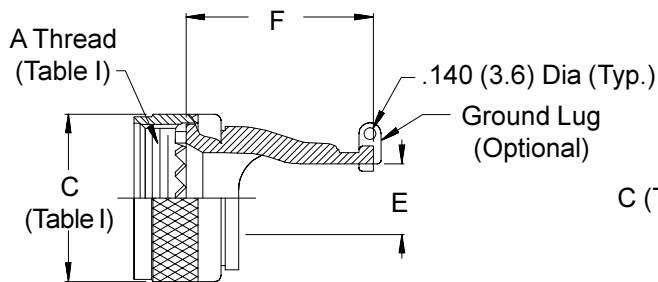

**STRAIGHT
ROTATABLE COUPLING**

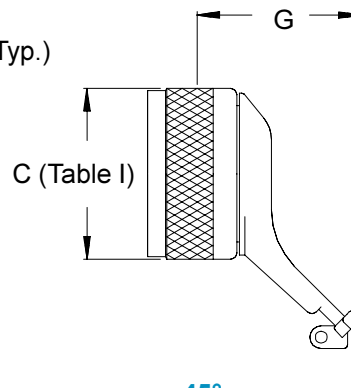

**45°
ROTATABLE COUPLING**

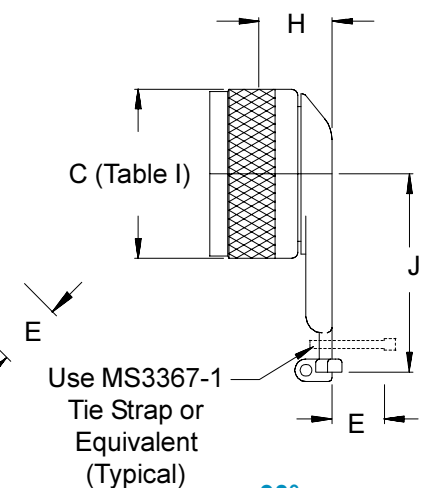

**90°
ROTATABLE COUPLING**

See inside back cover fold-out or pages 13 and 14 for Tables I and II.

Shell Size	E Cable Entry	F Max	G Max	H Max	J Max
08	.269 (6.8)	.866 (22.0)	1.066 (27.1)	.464 (11.8)	.890 (22.6)
10	.397 (10.1)	.866 (22.0)	1.066 (27.1)	.496 (12.6)	.950 (24.1)
12	.511 (13.0)	.926 (23.5)	1.066 (27.1)	.535 (13.6)	1.070 (27.2)
14	.636 (16.2)	1.106 (28.1)	1.188 (30.2)	.574 (14.6)	1.330 (33.8)
16	.761 (19.3)	1.106 (28.1)	1.224 (31.1)	.590 (15.0)	1.390 (35.3)
18	.850 (21.6)	1.176 (29.9)	1.224 (31.1)	.685 (17.4)	1.480 (37.6)
20	.975 (24.8)	1.306 (33.2)	1.224 (31.1)	.685 (17.4)	1.660 (42.2)
22	1.100 (27.9)	1.426 (36.2)	1.224 (31.1)	.716 (18.2)	1.850 (47.0)
24	1.225 (31.1)	1.556 (39.5)	1.224 (31.1)	.755 (19.2)	1.910 (48.5)

1. Cable Entry is defined as the accommodation entry for the wire bundle or cable. Dimensions are not intended for inspection criteria.
2. Metric dimensions (mm) are indicated in parentheses.